



Practical information for participants at EURALEX 2022

Travel:

We would like to draw your attention to the “9-Euro-Ticket”, which you can purchase online at <https://www.bahn.com/en/offers/regional/9-euro-ticket-en> or alternatively at ticket machines for tram/bus tickets in Mannheim. For € 9.00 (a personalized ticket), you can travel throughout Germany on all local trains (no ICE, IC, EC trains) and public transport, e.g. tram and bus, in Mannheim for the entire month of July.

Important information about the stop “Mannheim Hauptbahnhof” for the trams and city buses:

The bus and tram stop “Mannheim Hauptbahnhof” is currently closed due to construction work. This results in extensive detours on tram lines 1, 3, 4/4A, 5/5A, 8, 9 and 15. Fortunately, most of the hotels on our website as well as our venue are within walking distance of the train station. Otherwise, you will find taxis outside the train station.

More information on travel can be found here: <https://euralex2022.ids-mannheim.de/venue/#travel>.

Covid-19:

Please inform yourself about the entry requirements for Germany here: <https://www.bundesgesundheitsministerium.de/en/service/gesetze-und-verordnungen/guv-19-lp/coronavirus-einreiseverordnung.html>.

At the moment there are no restrictions for attending the event, staying in hotels, eating in restaurants, visiting shops, etc. Mandatory masks (surgical masks or FFP2 masks) are required on public transport, in doctors’ practices, in emergency rooms, in hospitals, etc. Testing obligations exist only in hospitals, etc. For details see <https://www.baden-wuerttemberg.de/en/service/aktuelle-infos-zu-corona/corona-information-in-other-languages/>.

We recommend wearing a surgical mask or FFP2 mask in all public areas as well as in the lecture halls of our venue, Mannheim Palace. We also recommend keeping a distance of 1.5 m from other people. We have reserved large lecture halls with a generous number of seats to maintain free spaces between participants. We have also planned more space than usual for the coffee breaks and the poster session. Disinfectant dispensers will be available throughout the venue.

We kindly ask all participants to test themselves before coming to Mannheim as well as every morning before joining the conference so as to minimize the infection risk for everybody. Free test kits as well as face masks will be available at the conference office.

Venue

Please note: The **conference** will take place in the **East Wing of Mannheim Palace**. So do not enter the castle via the central courtyard and the main building, but on the left side (when facing the building). You will find our registration tables for the conference on the first conference day (12 July 2022) directly upon entering the building. On all other days, registration is possible at the conference office (see next page).

For the **reception** (12 July; from 6 PM) please enter the castle via the central courtyard. If you go straight across the central courtyard, you will find the entrance to the “Gartensaal” a little to the right, where we will be happy to welcome you to the reception.

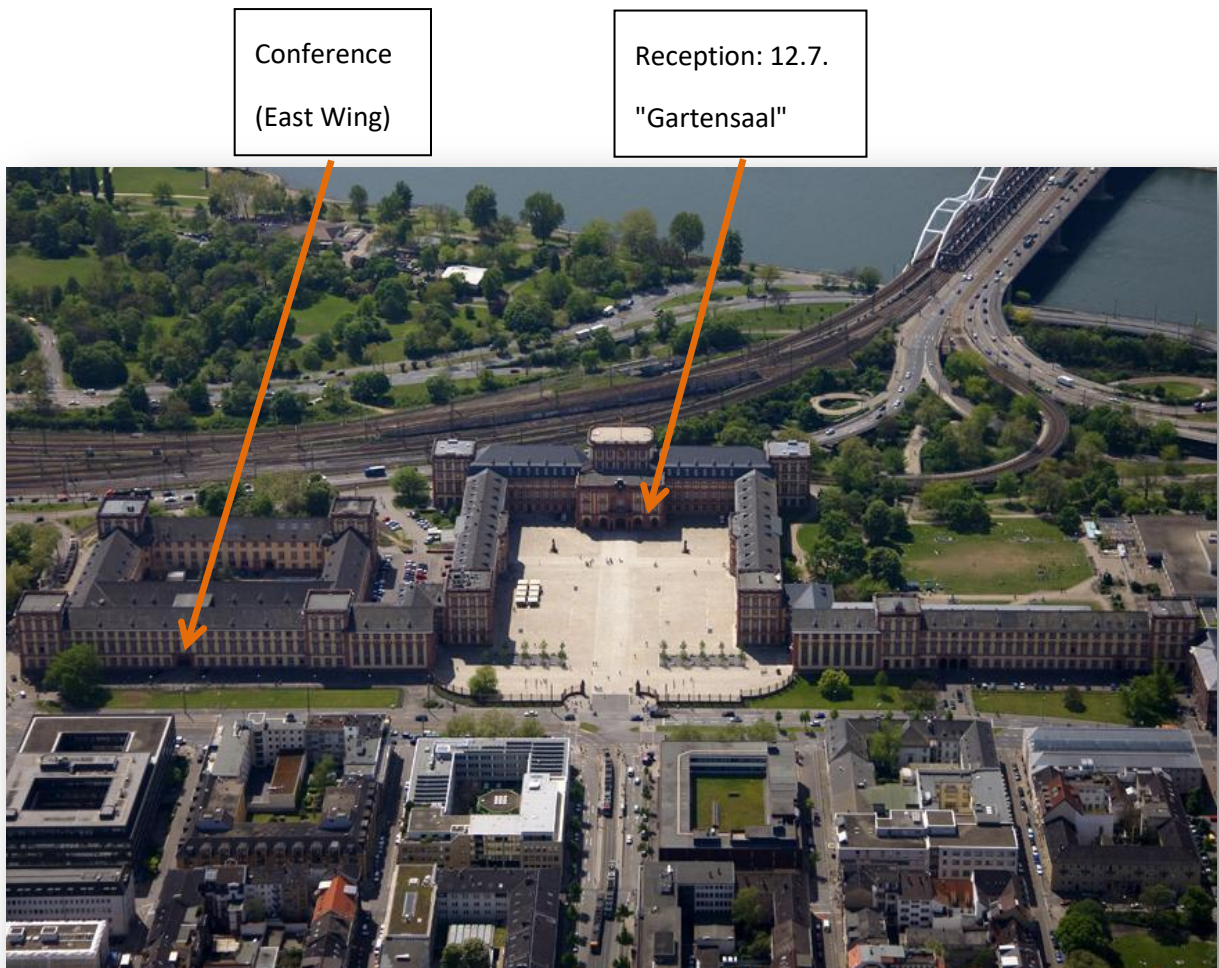

Conference Rooms (East Wing)

In addition to the auditorium, the lecture halls and the “Aula” for keynotes, talks, software demonstrations, poster session and project fair, there is an indoor lounge area (in the same room as the conference office) and an outdoor lounge area for you to use as you wish. We have also reserved a meeting room which you can use on a first-come, first-served basis. Coffee breaks take place in the "Katakomben", a water station is located outside the lounge.

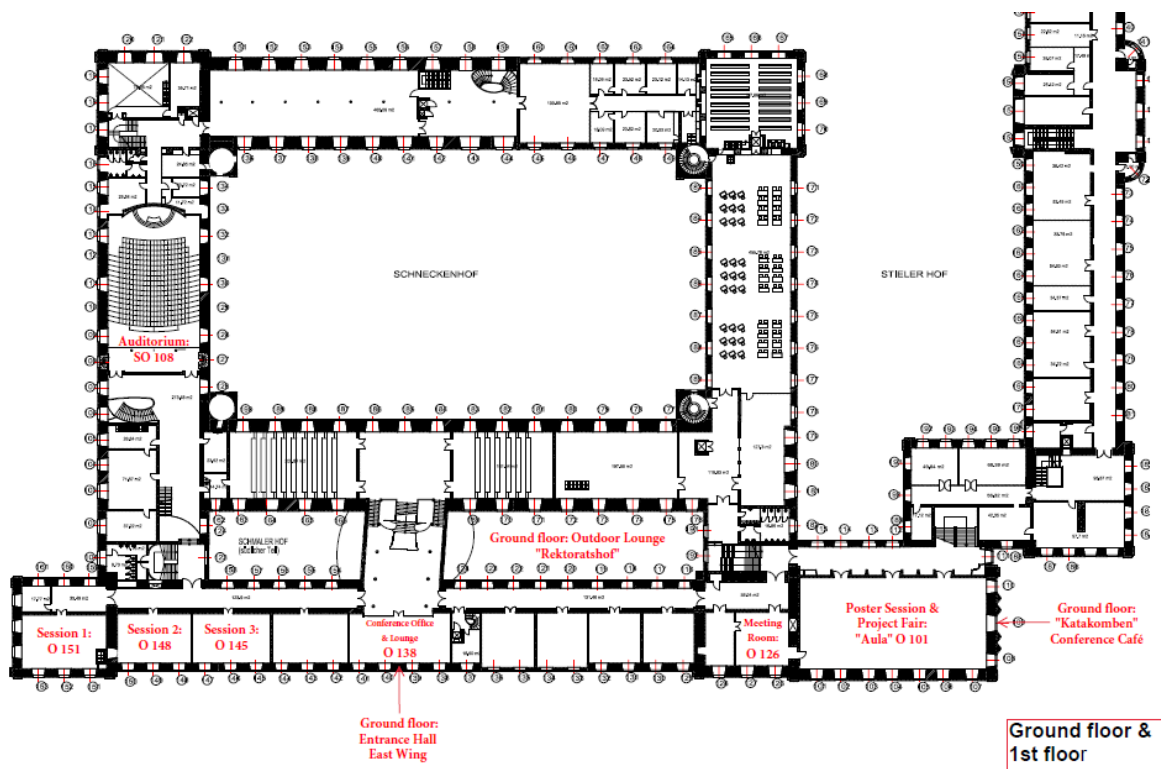

The rooms at Mannheim Palace are not air-conditioned as standard, but they are all connected to a ventilation system. Since the rooms are very high and the walls very thick, the entire castle has a quite pleasant indoor climate even on very warm days.